

## Senior Play Area

This world first tower is over 7m tall and consists of a large 3D climbing web that challenges the user who is rewarded at the top with an exhilarating slide down the large Stainless Steel tube slide. The tower is connected to an adventure course climbing structure with a variety of activities of climbing, balancing, scrambling as well as upper body monkey bars or just hanging out in the lookout nest.

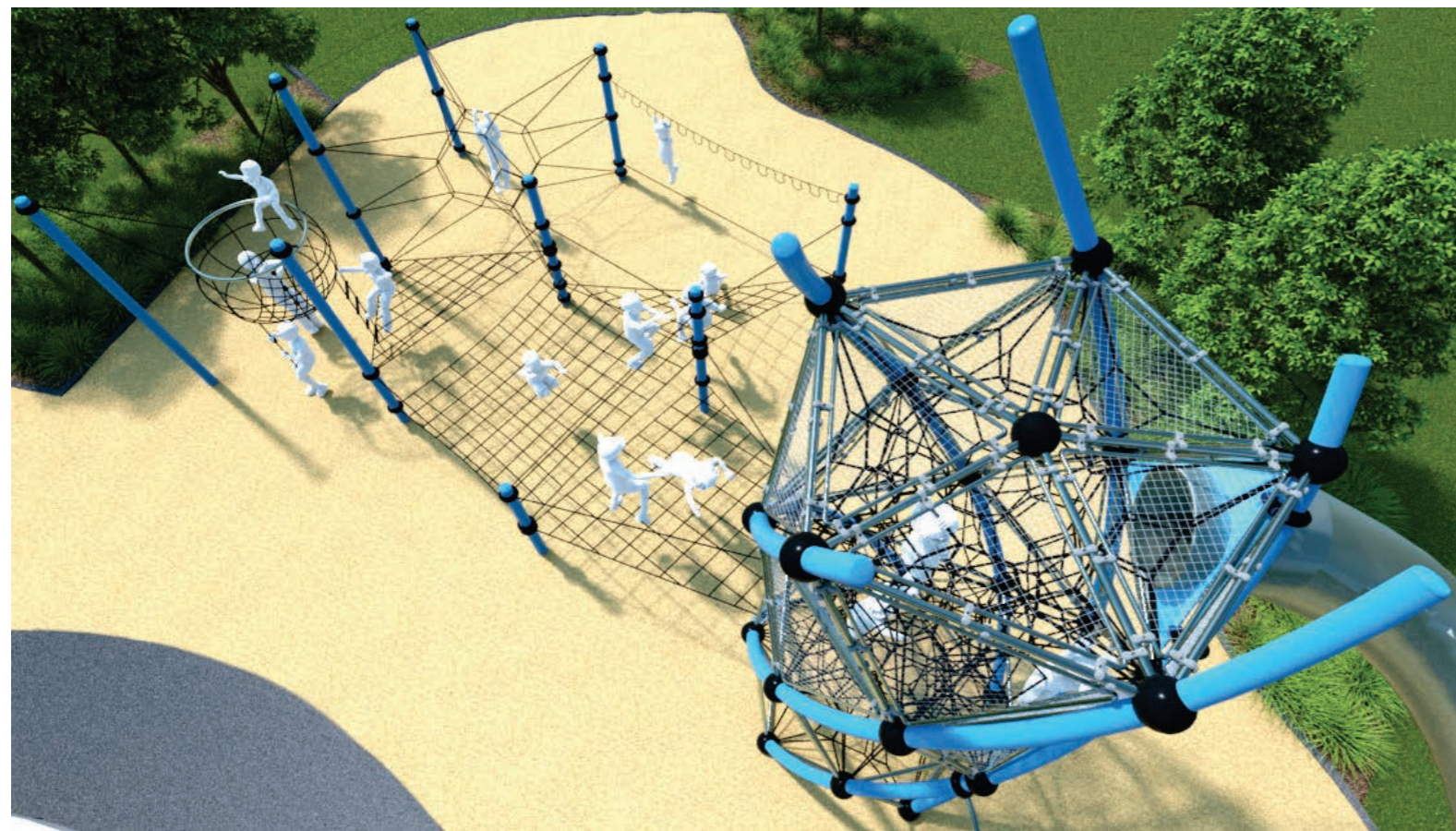
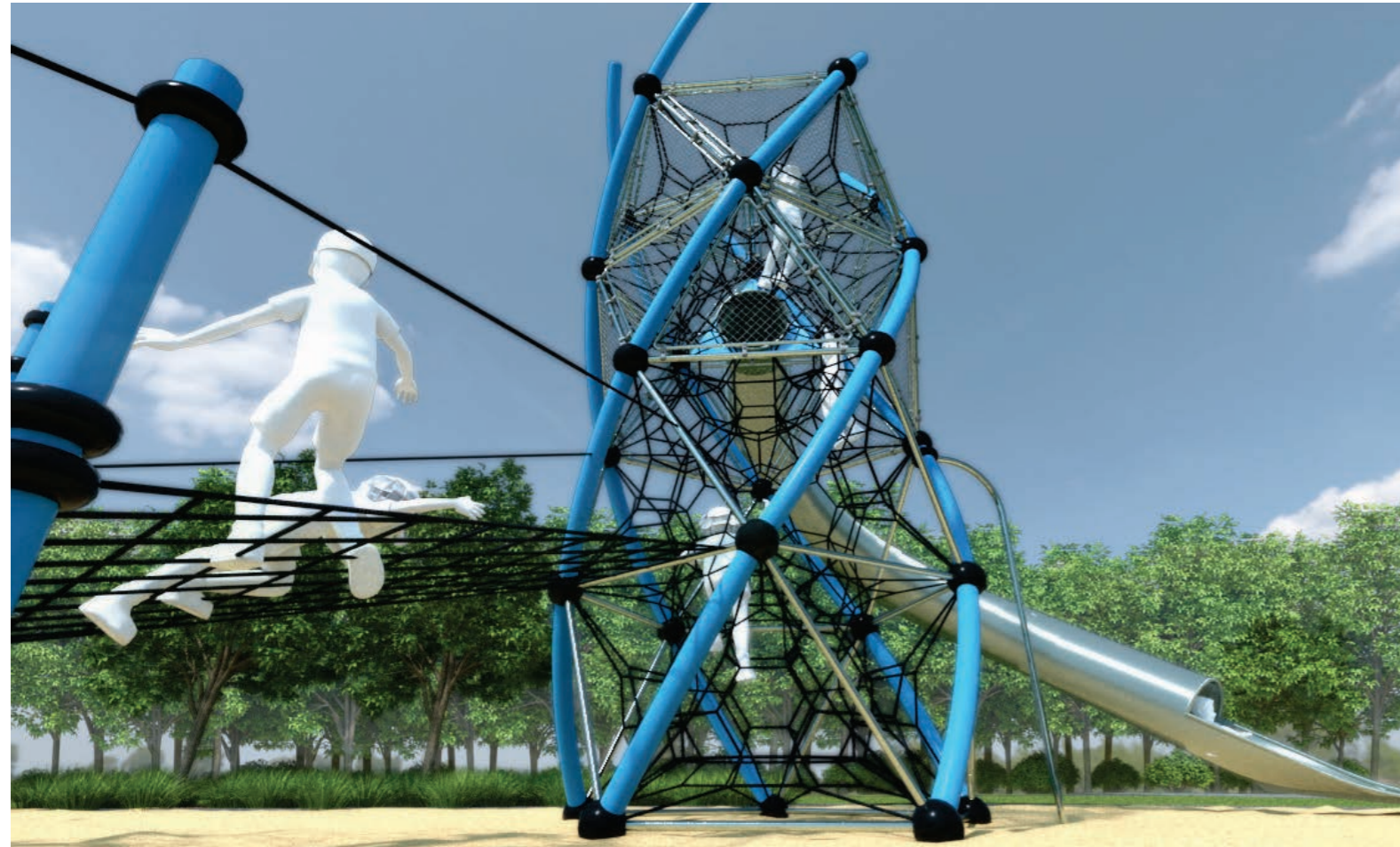

## Junior Play Area

The Junior Play area consist of exciting undulating mounding with an embankment slide and rubber dome steppers, that create interest not only in land form but play value for lower age groups. The children can then race across to the in-ground trampoline and bounce, before spinning on the carousel. This creates a fun circuit for children and is accessible to many different age groups and abilities. The stainless steel sand and water play allows for sensory and cognitive play that is extremely robust and timeless in aesthetic. Lastly children of all ages and ability can swing together in the multi swing. The swing contains a basket, toddler and standard seat which would allow for the entire family to swing together.



Mound Slide



Mound Slide

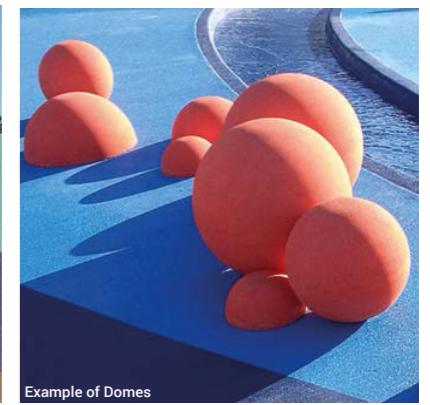

Example of Domes



In-ground Trampoline



Undulating Land form with Trampolines



Example of Water Play



Example of Water Play



Example of Water Play



Multi Swing (Basket, Toddler & Standard Seat)



Hoop Carousel